

SRB SERIES

* قطعات موجود در انبار بقیه سایز ها به زودی

Radial Beam Coupling (Ultra High Strength Aluminum Alloy Body)

Set-screw (SRB-no mark)

Side-clamp (SRB-C)

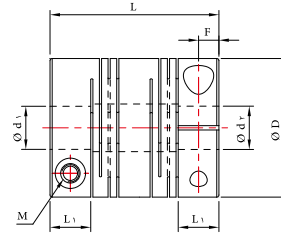
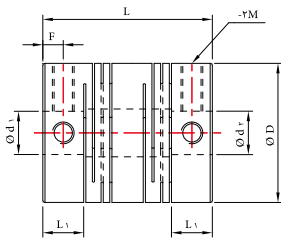

Dimensions / Performance

Set-screw

Model	Size ($\pm 0.3\text{mm}$)				Screw		Rated Torque (N·m)	Max. Torque (N·m)	Max. rpm (min^{-1})	Moment of Inertia ($\text{kg}\cdot\text{m}^2$)	Static Torsional Stiffness (N·m/rad)	Mass (g)	Permissible Misalignment		
	D	L	L ₁	F	Size	Fastening Torque (N·m)							Angular (°)	Parallel (mm)	End-play (mm)
SRB-8	7.9	14	3.5	1.7	M2	0.3	0.1	0.2	50,000	1.2×10^{-8}	16	1.5	2.5	0.1	± 0.2
SRB-12	12.7	18	4.5	2.2	M2.5	0.5	0.2	0.4	40,000	1.1×10^{-7}	40	4.4	2.5	0.1	± 0.3
SRB-16	16	18.5	4.7	2.3	M3	0.7	0.4	0.8	30,000	2.8×10^{-7}	75	7.2	2.5	0.15	± 0.3
SRB-19	19.1	22	6	2.9	M3	0.7	0.6	1.2	24,000	6.4×10^{-7}	150	12	2.5	0.15	± 0.3
SRB-22	22.2	25	6.5	3.2	M4	1.7	1	2	20,000	1.4×10^{-6}	200	17.4	2.5	0.15	± 0.4
SRB-26	26.2	30	7.7	3.4	M4	1.7	2	4	18,000	3.1×10^{-6}	340	29.2	2.5	0.2	± 0.4
SRB-32	31.8	39	9.4	4.7	M5	4	3.8	7.6	18,000	9.4×10^{-6}	450	56.8	2.5	0.2	± 0.4
SRB-39	39	56	16	5.9	M5	4	7	14	12,000	2.8×10^{-5}	640	124	2.5	0.25	± 0.4
SRB-49	49	70	19.8	9.4	M6	7	15	30	10,000	1.0×10^{-4}	1,500	280	2.5	0.25	± 0.5
SRB-60	60	88	19	9	M8	15	30	60	8,500	2.7×10^{-4}	2,500	500	2.5	0.3	± 0.5

- The Moment of Inertia and Mass values are based on products with max. Inner diameter.
- The number of screw for SRB-8 is 1pc.
- Max. torque/rated torque is the value regarding to a coupling's self-durability and is not related to slip-torque between the coupling bore and the shaft. (Set-screw type is usually less durable than other clamping method, thus please consider it has a complementary option e.g. keyway along with.)

Side-clamp

Model	Size ($\pm 0.3\text{mm}$)				Screw		Rated Torque (N·m)	Max. Torque (N·m)	Max. rpm (min^{-1})	Moment of Inertia ($\text{kg}\cdot\text{m}^2$)	Static Torsional Stiffness (N·m/rad)	Mass (g)	Permissible Misalignment		
	D	L	L ₁	F	Size	Fastening Torque (N·m)							Angular (°)	Parallel (mm)	End-play (mm)
SRB-12C	12.7	19	5	2.5	M2	0.5	0.2	0.4	35,000	1.1×10^{-7}	40	4.4	2.5	0.1	± 0.3
* SRB-16C	16	21.5	6.1	3	M2.6	1	0.4	0.8	27,000	3.1×10^{-7}	75	8.2	2.5	0.15	± 0.3
* SRB-19C	19.1	23	6.2	3.1	M2.6	1	0.6	1.2	20,000	6.4×10^{-7}	150	12	2.5	0.15	± 0.3
SRB-22C	22.2	26.5	7.2	3.6	M3	1.7	1	2	18,000	1.4×10^{-6}	200	17.9	2.5	0.15	± 0.4
* SRB-26C	26.2	31.5	7.5	3.7	M3	1.7	2	4	17,000	3.2×10^{-6}	340	29.9	2.5	0.2	± 0.4
SRBA-32C	31.8	39	9.4	4.7	M4	3.5	3.8	7.6	14,000	8.6×10^{-6}	450	54.9	2.5	0.2	± 0.4
SRBB-32C	31.8	44	9.4	4.7	M4	3.5	3.8	7.6	14,000	1.0×10^{-5}	450	62.3	2.5	0.2	± 0.4
* SRBA-39C	39	43	10.7	5.3	M5	8	7	14	10,000	2.1×10^{-5}	640	87.8	2.5	0.25	± 0.4
SRBB-39C	39	56	12	5.5	M5	8	7	14	10,000	2.8×10^{-5}	640	117	2.5	0.25	± 0.4
* SRBA-49C	49	63.5	15.1	7.5	M6	13	15	30	10,000	8.4×10^{-5}	1,500	236	2.5	0.25	± 0.5
SRBB-49C	49	70	14.5	7.2	M6	13	15	30	8,400	1.0×10^{-4}	1,500	258	2.5	0.25	± 0.5
* SRBA-60C	60	76.2	19	9.4	M8	30	30	60	7,000	2.2×10^{-4}	2,500	407	2.5	0.25	± 0.5
SRBB-60C	60	88	19	9.4	M8	30	30	60	7,000	2.6×10^{-4}	2,500	483	2.5	0.25	± 0.5

- The Moment of Inertia and Mass values are based on products with max. Inner diameter.
- Max. torque/rated torque is the value regarding to a coupling's self-durability and is not related to slip-torque between the coupling bore and the shaft.



SRB SERIES

* قطعات موجود در انبار بقیه سایز ها به زودی

Radial Beam Coupling (Ultra High Strength Aluminum Alloy Body)

Standard Inner Diameter (ID)

Model	Standard Inner Diameter (d_1, d_2) (mm)																			
	2	3	4	5	6	6.35	8	9.525	10	11	12	14	15	16	18	19	20	22	24	25
SRB-8□	●	●																		
SRB-12□		●	●	●																
SRB-16□		●	●	●	●															
SRB-19□			●	●	●	●	●													
SRB-22□				●	●	●	●	●	●											
SRB-26□				●	●	●	●	●	●	●										
SRB□-32□							●	●	●	●	●	●								
SRB□-39□									●	●	●	●	●	●	●	●				
SRB□-49□											●	●	●	●	●	●	●			
SRB□-60□													●	●	●	●	●	●	●	●

- The recommended shaft tolerance is h7.
- Custom process (e.g. non-standard Inner diameter, special tolerance etc.) is also available upon a special request in prior to order placement.
- Keyway is available. (Optional)

Slip Torque

- The below table shows the actual permissible torque values when the slip torque value is lower than the coupling's max. torque value.
- If the slip torque value is lower than the coupling's max. torque value, please check and compare between the slip torque in the below table and the operating torque value of the connected motor. It is safer to size up the coupling or use a key/keyway when the slip torque value is lower than the motor's operating torque.
- The below slip torque values may be subject to change according to different testing conditions. (e.g. shaft tolerance, Surface roughness, or acceleration/deceleration of driving shafts). On the other hand, the values could be affected when a different kind of fastening screw is used (body material or surface treatment). Therefore, we recommend you test under the same conditions before mounting.

Model	Max. Torque (N.m)	Slip Torque (N.m) by Inner Diameter (d_1, d_2)												
		5	6	6.35	8	9.525	10	11	12	14	15	16	18	19
SRB-26C	4	2.2	2.8	2.8	3.5									
SRB□-32C	7.6				5.6	7								
SRB□-39C	14						12							
SRB□-49C	30								21	27				
SRB□-60C	60										34	40	46	54

