

## SHD SERIES (SHDW)

\* قطعات موجود در انبار بقیه سایز ها به زودی

### Double Disk High Torque Disk Coupling

#### Side-clamp

| Cylinder-shaped |

| Flange-shaped (Low-inertia) |

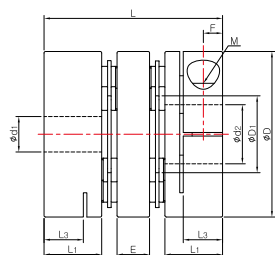

Size: 56C ~ 110C

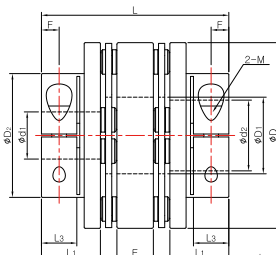

Size: 126C

### Dimensions / Performance

Model	Size (±0.3mm)								Screw		Rated Torque (N·m)	Max. Torque (N·m)	Max. rpm (min <sup>-1</sup> )	Moment of Inertia (kg·m <sup>2</sup> )	Static Torsional Stiffness (N·m/rad)	Mass (g)	Permissible Misalignment			Side-clamp Hub Split (W)
	D	D <sub>1</sub>	D <sub>2</sub>	L	L <sub>1</sub>	L <sub>3</sub>	F	E	Size	Fastening Torque (N·m)							Angular (°)	Parallel (mm)	End-play (mm)	
* SHDW-56C	56	28.6	-	60.4	19.5	13.3	6.5	11	M6	13	35	70	7,000	5.8×10 <sup>-5</sup>	1.0×10 <sup>4</sup>	300	1	0.2	±0.6	○
* SHDW-66C	66	35.6	-	80	24.5	15.5	7.5	16	M6	13	60	120	6,500	1.4×10 <sup>-4</sup>	1.5×10 <sup>4</sup>	520	1	0.2	±0.6	○
* SHDW-88C	88	46	-	99.8	30	19	10	20	M8	30	180	360	5,500	5.7×10 <sup>-4</sup>	3.5×10 <sup>4</sup>	1,200	1	0.2	±0.6	○
SHDW-110C	108	60.5	-	111	34.5	21	10.5	24.6	M10	50	280	560	4,000	3.7×10 <sup>-3</sup>	7.0×10 <sup>4</sup>	1,920	1	0.25	±1	○
SHDW-126C	126	65	84/*100	127.4	40	24	12	25	M10	50	360	720	3,500	1.3×10 <sup>-2</sup>	2.2×10 <sup>5</sup>	5,800	1	0.6	±3.2	○

- The Moment of Inertia and Mass values are based on products with max. Inner diameter.
- Max. torque/rated torque is the value regarding to a coupling's self-durability and is not related to slip-torque between the coupling bore and the shaft.
- For OD 126C products, please refer to D<sub>2</sub> values with \* mark when inner diameters are bigger than 45mm.

### Standard Inner Diameter (ID)

Model	Standard Inner Diameter (d <sub>1</sub> , d <sub>2</sub> ) (mm)																								
	10	11	12	14	15	16	18	19	20	22	24	25	26	28	30	32	35	38	40	42	45	48	50	55	60
SHDW-56C	●	●	●	●	●	●	●	●	●	●	●	●													
SHDW-66C					●	●	●	●	●	●	●	●	●	●	●	●									
SHDW-88C									●	●	●	●	●	●	●	●	●	●	●	●	●				
SHDW-110C															●	●	●	●	●	●	●	●	●	●	●
SHDW-126C															●	●	●	●	●	●	●	●	●	●	●

- The recommended shaft tolerance is h7.
- Custom process (e.g. non-standard Inner diameter, special tolerance etc.) is also available upon a special request in prior to order placement.
- Keyway is available. (Optional)



## SHD SERIES (SHDW)

\* قطعات موجود در انبار بقیه سایزها به زودی

### Double Disk High Torque Disk Coupling

#### Slip Torque

- The below table shows the actual permissible torque values when the slip torque value is lower than the coupling's max. torque value.
- If the slip torque value is lower than the coupling's max. torque value, please check and compare between the slip torque in the below table and the operating torque value of the connected motor. It is safer to size up the coupling or use a key/keyway when the slip torque value is lower than the motor's operating torque.
- The below slip torque values may be subject to change according to different testing conditions. (e.g. shaft tolerance, Surface roughness, or acceleration/deceleration of driving shafts). On the other hand, the values could be affected when different kind of fastening screw is used. Therefore, we recommend you test under the same conditions before mounting.

Model	Max. Torque (N.m)	Slip Torque (N.m) by Inner Diameter ( $d_1, d_2$ )																									
		10	11	12	14	15	16	18	19	20	22	24	25	26	28	30	32	35	38	40	42	45	48	50	55	60	
SHDW-56C	70	22	24	30	30	32	40	45	55	61																	
SHDW-66C	120					40	40	45	60	62	64	68	70	97	100	104	117										
SHDW-88C	360									76	83	98	104	130	136	162	169	188	193	208	215	220					
SHDW-110C	560															162	170	182	199	221	235	247	253	273	299	273	
SHDW-126C	720															191	209	232	268	305	323	355	379	385	400	400	

#### Side-clamp Hub Split(W) Option is available

- From certain outer diameter (OD) sizes, we can provide Side-clamp Hub Split products.
- Please refer to "HOW TO ORDER" page for more details.
- The no. of fastening screws for OD 56~110 products is only 1 each, however we provide 2 screws for Side-clamp Split (W) type according to the below drawing.

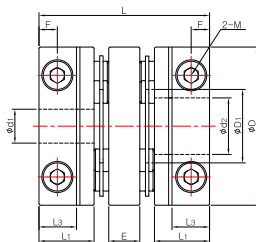

#### Electroless Nickel Plating for Steel-body Products

- The standard surface treatment (finish) for steel-body product is **Black Oxide**.
- If corrosion is highly concerned, there is another surface treatment option of 'Electroless Nickel Plating' adding an additional code "NI" next to the part no. as shown below.

**SHDW - 126C - NI - 30 - 40**

- All other parts (collars, ASS screws and FAS screws) will be Electroless Nickel Plated as well.



- Caution: Slip torque would become lower if the body material or surface treatment of screws are changed from the standard version.

