

## Pneumatic Push-Pull Type Toggle Clamps

662

new



MODEL NO	F1 (N)	F3 (N)	Fi (N)	Vn (dm <sup>3</sup> )	STROK	WEIGHT (gr)	BAR
662-3 (Ø 12)	1500	2960	300	0,25	23	860	6
662-3 (Ø 14)	2500	3200	500	0,51	23	1010	6

F1 : BASKI KUVVETİ ( EXERTING FORCE ) , F3 : TUTMA KAPASİTESİ ( HOLDING CAPACITY ) , Fi : UYGULAMA KUVVETİ ( APPLIED FORCE )

Vn , 6 BAR BASINÇTA ÇİFT HAREKET İÇİN HAVA TÜKETİM MİKTARIDIR ( Vn , AIR CONSUMPTION PER DOUBLE STROKE IN dm<sup>3</sup> AT 6 BAR )

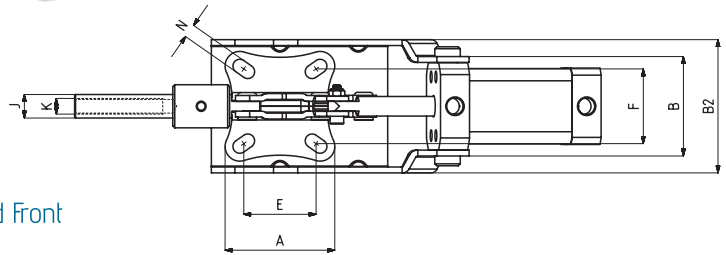
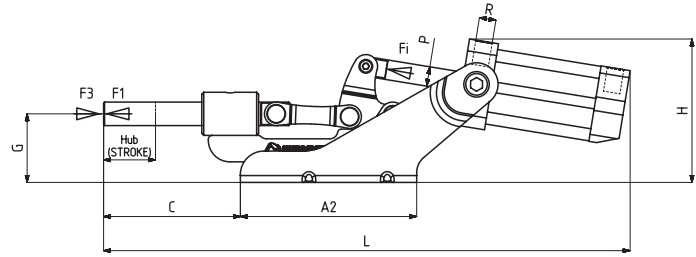

Body Mounting Base Horizontal With Welding, Tied Front

With Square Piston and Sensor Slot

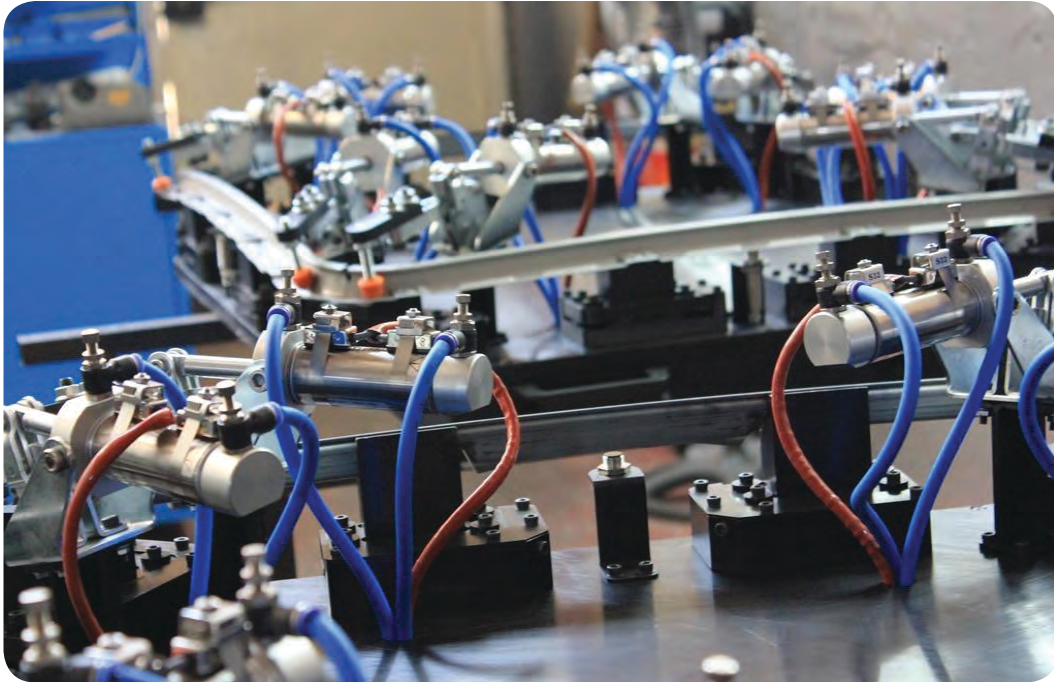

Pneumatic cylinders are double acting, magnetic and cushioning

MODEL NO	A	A2	B	B2	C	D	E	E2	F	G	H	J	K	L	M	N	P	R	PISTON Ø
662-3 (Ø 12)	56	90	51	68	70		32,5 - 41		35 - 41	35	73	12	M8	268		7 x 12	Ø 10	G1/8	25
662-3 (Ø 14)	56	100	58	68	70		32,5 - 41		35 - 41	35	80	14	M8	288		7 x 12	Ø 12	G1/8	32



تلفن : (021) 33913364 - 33951660

فکس : (021) 33985603