

## Nut/T Slot Nut/Slot 6

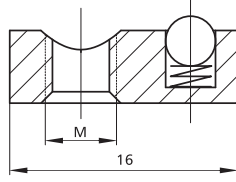

Slot	Item No.	Spec.	Material	Finish	PCS/CTN	KGS/CTN	CTN SIZE (mm)
6	2048-1	M4	Steel	Zinc Blue	4,000	17.95	225*170*180
6	2048-2	M5	Steel	Zinc Blue	4,000	16.85	225*170*180
6	2048-3	M6	Steel	Zinc Blue	4,000	15.75	225*170*180
6	2048-1SS	M4	SS 304/1.4301	Polished	4,000	18.35	225*170*180
6	2048-2SS	M5	SS 304/1.4301	Polished	4,000	17.45	225*170*180
6	2048-3SS	M6	SS 304/1.4301	Polished	4,000	16.25	225*170*180

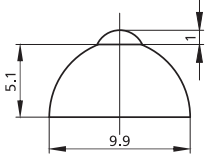