

Linear Motion Component ► Guides & Bearings ► Slide Table

GRM / GRM - N / GRM - B

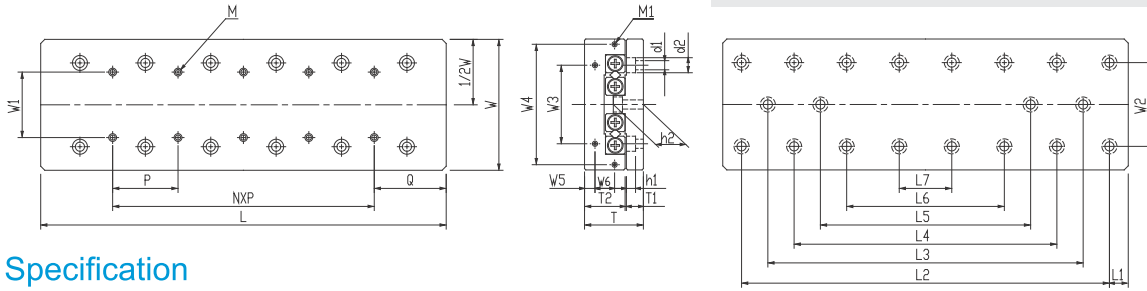

Specification

Model No.			Max. Stroke (mm)	Roller Dia. (mm)	Main Dimensions (mm)				Table Mounting Dimensions (mm)				External Connection Mounting Dimensions (mm)									
Standard	Antirust	Black Coating			W	T	T ₂	L	W ₁	M	Q	N*P	W ₃	W ₄	W ₅	W ₆	M ₁	W ₂	d ₁	d ₂	h ₁	T ₁
GRM30-25	GRM30-25-N	GRM30-25-B	12	Ø1.5	30 ^{±0.03}	17±0.1	11	25	10	M2*4L	12.5	/	12	/	2.5	/	M2*6L	22	2.5	4.5	2.5	5.5
GRM30-35	GRM30-35-N	GRM30-35-B	18					35				1*10										
GRM30-45	GRM30-45-N	GRM30-45-B	25					45				2*10										
GRM30-55	GRM30-55-N	GRM30-55-B	32					55				3*10										
GRM30-65	GRM30-65-N	GRM30-65-B	40					65				4*10										
GRM30-75	GRM30-75-N	GRM30-75-B	45					75				5*10										
GRM30-85	GRM30-85-N	GRM30-85-B	50					85				6*10										
GRM40-35	GRM40-35-N	GRM40-35-B	18	Ø2.0	40 ^{±0.03}	21±0.1	14	35	15	M3*6L	17.5	/	16	/	3.4	/	M2*6L	30	3.5	6.5	3.5	6.5
GRM40-50	GRM40-50-N	GRM40-50-B	30					50				1*15										
GRM40-65	GRM40-65-N	GRM40-65-B	40					65				2*15										
GRM40-80	GRM40-80-N	GRM40-80-B	50					80				3*15										
GRM40-95	GRM40-95-N	GRM40-95-B	60					95				4*15										
GRM40-110	GRM40-110-N	GRM40-110-B	70					110				5*15										
GRM40-125	GRM40-125-N	GRM40-125-B	80					125				6*15										
GRM40-140	GRM40-140-N	GRM40-140-B	90					140				7*15										
GRM40-155	GRM40-155-N	GRM40-155-B	100					155				8*15										
GRM40-170	GRM40-170-N	GRM40-170-B	110					170				9*15										
GRM40-185	GRM40-185-N	GRM40-185-B	120	185	10*15																	
GRM60-55	GRM60-55-N	GRM60-55-B	30	Ø3.0	60±0.1	28±0.1	18.5	55	25	M4*8L	27.5	/	40	/	5.5	/	M3*6L	40	4.5	8	4.5	9
GRM60-80	GRM60-80-N	GRM60-80-B	45					80				1*25										
GRM60-105	GRM60-105-N	GRM60-105-B	60					105				2*25										
GRM60-130	GRM60-130-N	GRM60-130-B	75					130				3*25										
GRM60-155	GRM60-155-N	GRM60-155-B	90					155				4*25										
GRM60-180	GRM60-180-N	GRM60-180-B	105					180				5*25										
GRM60-205	GRM60-205-N	GRM60-205-B	130					205				6*25										
GRM60-230	GRM60-230-N	GRM60-230-B	155					230				7*25										
GRM60-255	GRM60-255-N	GRM60-255-B	180					255				8*25										
GRM60-280	GRM60-280-N	GRM60-280-B	205					280				9*25										
GRM60-305	GRM60-305-N	GRM60-305-B	230	305	10*25																	

Ordering Example :	GRM	30	25	N
	M type table	Table width	Table length	Antirust

Linear Motion Component ◀ Guides & Bearings ▶ Slide Table

GRM / GRM - N / GRM - B

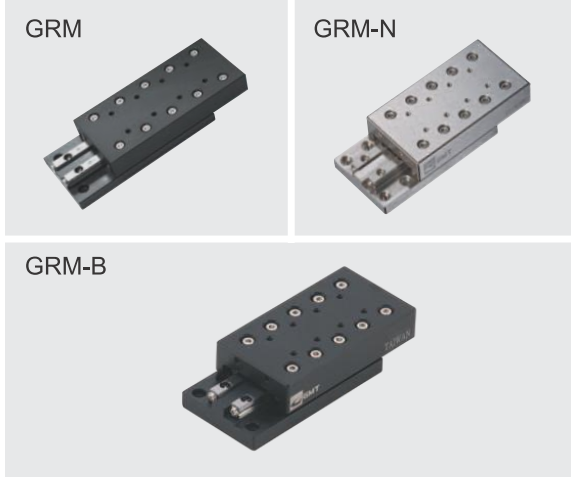

Material Specification

Component Material Model No.	Table	Rail	Retainer	Roller
GRM	Aluminum alloy +black anodized	SUJ2	SUS304	SUJ2
GRM - N	S50C+Ni	SUJ2+Ni	SUS304	SUJ2
GRM - B	S50C +phosphate	SUJ2	SUS304	SUJ2

GRM-N No Surface finished to V-groove surface of the rail.

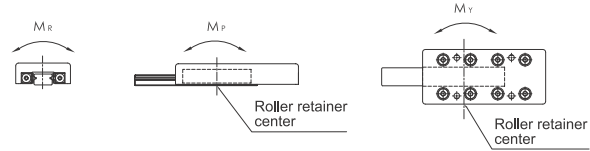

★ Each of load and torque changes oppositely in stroke variation

Base Mounting Dimensions (mm)							Basic Dynamic Load Rating C(N)	Basic Static Load Rating Co(N)	Allow-able Load Fu(N)	Static Rated Moment			Weight (kg)		Table Moving Accuracy (μm)		
h ₂	L ₁	L ₂	L ₃	L ₄	L ₅	L ₆				L ₇	M _R (N·m)	M _P (N·m)	M _V (N·m)	Standard	Antirust	Center Parallelism	Side Parallelism
9	3.5	18	/	/	/	/	/	379	576	192	2.6	1.2	1.4	0.04	0.09	2	4
		28						523	865	288	3.9	2.6	3.0	0.05	0.12		
		38						657	1,153	384	5.2	4.6	5.2	0.07	0.16		
		48						783	1,441	480	6.5	7.2	7.9	0.08	0.19		
		58						903	1,729	576	7.8	10.4	11.2	0.10	0.23	5	
		68						1,131	2,306	769	10.4	18.4	17.3	0.12	0.27		
		78						1,240	2,594	865	11.7	23.3	22.0	0.13	0.30		
10.9	5	25	/	/	/	/	/	895	1,170	390	7.0	3.1	3.9	0.09	0.20	2	4
		40						1,552	2,339	780	14.0	12.5	10.9	0.13	0.29		
		55						1,849	2,924	975	17.5	19.5	17.5	0.17	0.38		
		70						2,134	3,509	1,170	21.1	28.1	30.4	0.21	0.46		
		85						2,407	4,093	1,364	24.6	38.2	40.9	0.25	0.55	3	6
		100						2,930	5,263	1,754	31.6	63.2	59.6	0.30	0.64		
		115						3,181	5,848	1,949	35.1	78.0	74.1	0.34	0.73		
		130						3,427	6,433	2,144	38.6	94.3	98.6	0.38	0.82		
		145						3,668	7,017	2,339	42.1	112.3	117.0	0.42	0.91	7	
		160						4,136	8,187	2,729	49.1	152.8	147.4	0.46	1.00		
		175						4,365	8,772	2,924	52.6	175.4	169.6	0.50	1.08		
15	10	35	/	/	/	/	/	2,901	4,567	1,522	42.6	22.8	26.6	0.29	0.66	2	5
		60						4,338	7,611	2,537	71.0	63.4	57.1	0.43	0.96		
		85						5,646	10,655	3,552	99.5	124.3	115.4	0.57	1.26	3	6
		110						6,268	12,178	4,059	113.7	162.4	172.5	0.71	1.57		
		135						7,462	15,222	5,074	142.1	253.7	266.4	0.84	1.87		
		160						8,603	18,266	6,089	170.5	365.3	350.1	0.98	2.17		
		185						9,157	19,789	6,596	184.7	428.8	445.2	1.12	2.47		
		210						9,702	21,311	7,104	198.9	497.3	515.0	1.25	2.77		
		235						10,767	24,355	8,118	227.3	649.5	629.2	1.39	3.07		
		260						11,288	25,877	8,626	241.5	733.2	711.6	1.53	3.37		
		285						11,802	27,400	9,133	255.7	822.0	844.8	1.66	3.68		

Linear Motion Component ► Guides & Bearings ► Slide Table

GRM / GRM - N / GRM - B

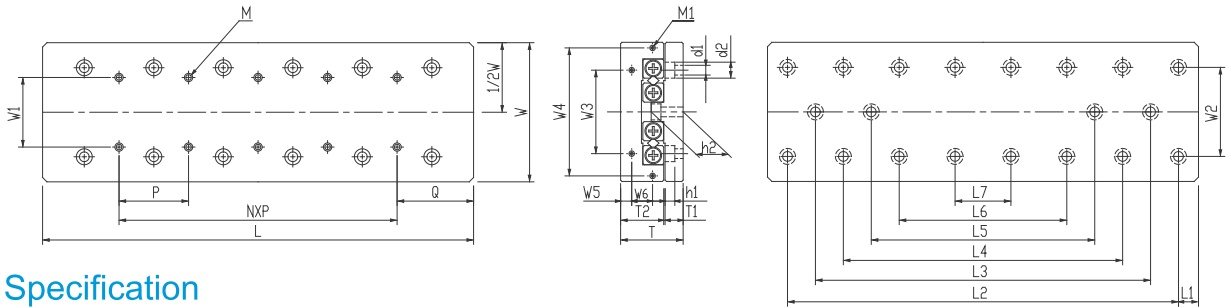
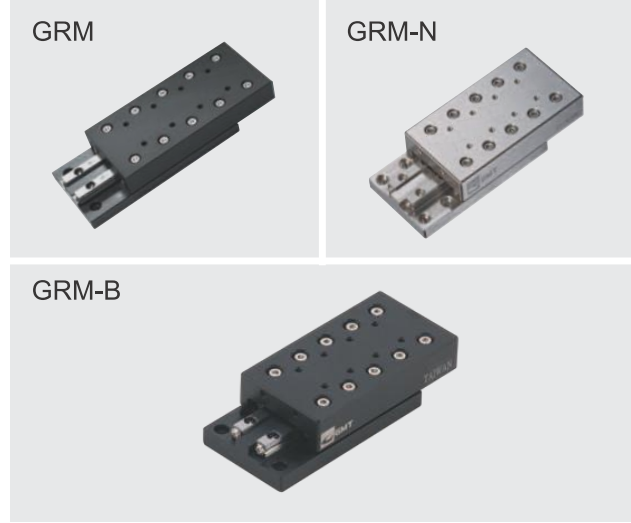

Specification

Model No.			Max. Stroke (mm)	Roller Dia. (mm)	Main Dimensions (mm)				Table Mounting Dimensions (mm)				External Connection Mounting Dimensions (mm)									
Standard	Antirust	Black Coating			W	T	T ₂	L	W ₁	M	Q	N*P	W ₃	W ₄	W ₅	W ₆	M ₁	W ₂	d ₁	d ₂	h ₁	T ₁
GRM80-85	GRM80-85-N	GRM80-85-B	50	4.0	80±0.1	35±0.1	24	85	40	M5*10L	42.5	55	/	/	/	/	/	/	/	/	/	
GRM80-125	GRM80-125-N	GRM80-125-B	75					125														1*40
GRM80-165	GRM80-165-N	GRM80-165-B	105					165														2*40
GRM80-205	GRM80-205-N	GRM80-205-B	130					205														3*40
GRM80-245	GRM80-245-N	GRM80-245-B	155					245														4*40
GRM80-285	GRM80-285-N	GRM80-285-B	185					285														5*40
GRM80-325	GRM80-325-N	GRM80-325-B	210					325														6*40
GRM80-365	GRM80-365-N	GRM80-365-B	235					365														7*40
GRM80-405	GRM80-405-N	GRM80-405-B	265					405														8*40
GRM100-110	GRM100-110-N	GRM100-110-B	60					6.0														100±0.1
GRM100-160	GRM100-160-N	GRM100-160-B	95	160	1*50																	
GRM100-210	GRM100-210-N	GRM100-210-B	130	210	2*50																	
GRM100-260	GRM100-260-N	GRM100-260-B	165	260	3*50																	
GRM100-310	GRM100-310-N	GRM100-310-B	200	310	4*50																	
GRM100-360	GRM100-360-N	GRM100-360-B	235	360	5*50																	
GRM100-410	GRM100-410-N	GRM100-410-B	265	410	6*50																	
GRM100-460	GRM100-460-N	GRM100-460-B	300	460	7*50																	
GRM100-510	GRM100-510-N	GRM100-510-B	335	510	8*50																	

Ordering Example :	GRM	30	25	N
	M type table	Table width	Table length	Antirust

Linear Motion Component ► Guides & Bearings ► Slide Table

GRM / GRM - N / GRM - B

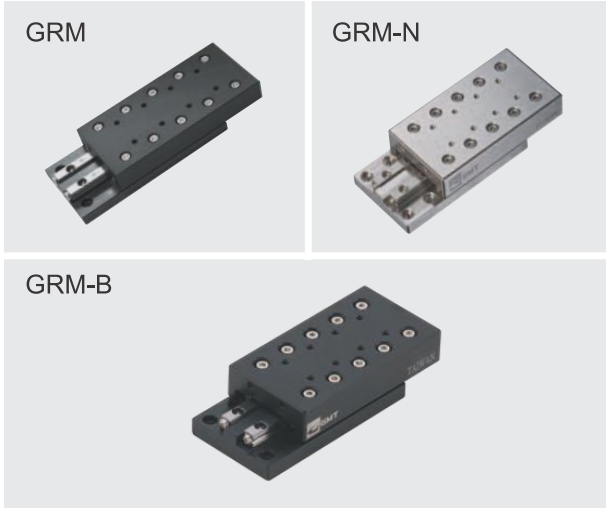

Material Specification

Component Material Model No.	Table	Rail	Retainer	Roller
GRM	Aluminum alloy +black anodized	SUJ2	SUS304	SUJ2
GRM - N	S50C+Ni	SUJ2+Ni	SUS304	SUJ2
GRM - B	S50C +phosphate	SUJ2	SUS304	SUJ2

GRM-N No Surface finished to V-groove surface of the rail.

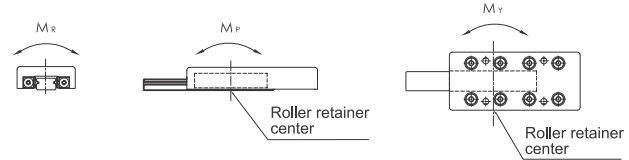

★ Each of load and torque changes oppositely in stroke variation

Base Mounting Dimensions (mm)								Basic Dynamic Load Rating C(N)	Basic Static Load Rating Co(N)	Allow-able Load Fu(N)	Static Rated Moment			Weight (kg)		Table Moving Accuracy (μ m)													
h_2	L_1	L_2	L_3	L_4	L_5	L_6	L_7				M_R (N·m)	M_p (N·m)	M_y (N·m)	Standard	Antirust	Center Parallelism	Side Parallelism												
10.5	10.5	65	/	/	/	/	/	6,617	9,357	3,119	124.8	87.3	76.4	0.76	1.69	2	5												
		105						9,097	14,035	4,678	187.1	196.5	180.1	1.12	2.50														
		145						10,264	16,375	5,458	218.3	267.5	286.6	1.48	3.31														
		10.5	10.5					185	105	/	/	/	/	12,492	21,053	7,018	280.7	442.1	466.7	1.84	4.11	3	7						
								225	145					14,612	25,732	8,577	343.1	660.4	690.5	2.20	4.91								
								265	185					16,646	30,410	10,137	405.5	922.4	957.9	2.56	5.72								
								10.5	10.5					305	225	145	/	/	/	18,612	35,089	11,696	467.8	1228.1	1269.0	2.92	6.51	4	8
														345	265	185				20,519	39,767	13,256	530.2	1577.4	1623.8	3.28	7.32		
														385	305	225				22,377	44,445	14,815	592.6	1970.4	1918.6	3.65	8.13		
23	10			90	/	/	/							/	/	13,923				21,053	7,018	315.8	252.6	221.1	1.60	3.48	3	6	
				140												16,592				26,316	8,772	394.7	394.7	434.2	2.36	5.10			
				190												90				21,596	36,842	12,281	552.6	773.7	828.9	3.11			6.70
		23	10	240	140					/	/	/	/			26,285				47,369	15,790	710.5	1279.0	1207.9	3.86	8.32	3	7	
				290	190											30,744				57,895	19,298	868.4	1910.5	1823.7	4.62	9.94			
				340	240											140				35,024	68,421	22,807	1026.3	2688.4	2565.8	5.36			11.53
				23	10			390	290							190	/	/	/	39,160	78,948	26,316	1184.2	3552.6	3434.2	6.12	13.15	4	8
								440	340							240				41,181	84,211	28,070	1263.2	4042.1	4168.4	6.87	14.76		
								490	390							290				190	45,141	94,737	31,579	1421.1	5115.8	5257.9	7.62		